

rotary seal R11-F

seal spec

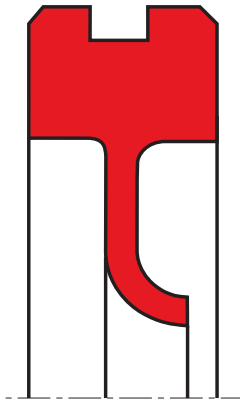

description

space saving rotary seal, deformed sealing lip acts selfadjusting on in-creasing temperature. for axially open housings with clamping plate fixation, elastic sec-ondary seal or integrated o-ring necessary for static sealing in the housing. excel-lent chemical and thermal resistance, suitable for high speed applications.

application



category of profile

machined only

double acting rotary shaft seal

operating parameters & material

diameter range: up to 600 mm

material	temperature	max. speed	max. pressure ¹
s-mart PTFE glass	-200 °C ... +260 °C	20 m/s	5 bar (0,5 MPa)
s-mart PTFE bronze	-200 °C ... +260 °C	20 m/s	5 bar (0,5 MPa)
s-mart PTFE carbon	-200 °C ... +260 °C	20 m/s	5 bar (0,5 MPa)

the stated operation conditions represent general indications. it is recommended not to use all maximum values simultaneously.
surface speed limits apply only to the presence of adequate lubrication film.

¹ pressure ratings are dependent on the size of the extrusion gap.

surface quality

surface roughness	Rtmax (µm)	Ra (µm)
shaft	≤6,3	≤0,2-0,8
bottom of groove	≤25	≤1,6-6,3

tolerance recommendation

seal housing tolerances	
Ød	h10
ØD	H10



seal & housing recommendations

please note that we are able to produce those profiles to your specific need or any non standard housing. for detail measurements, please see seal-mart catalog...

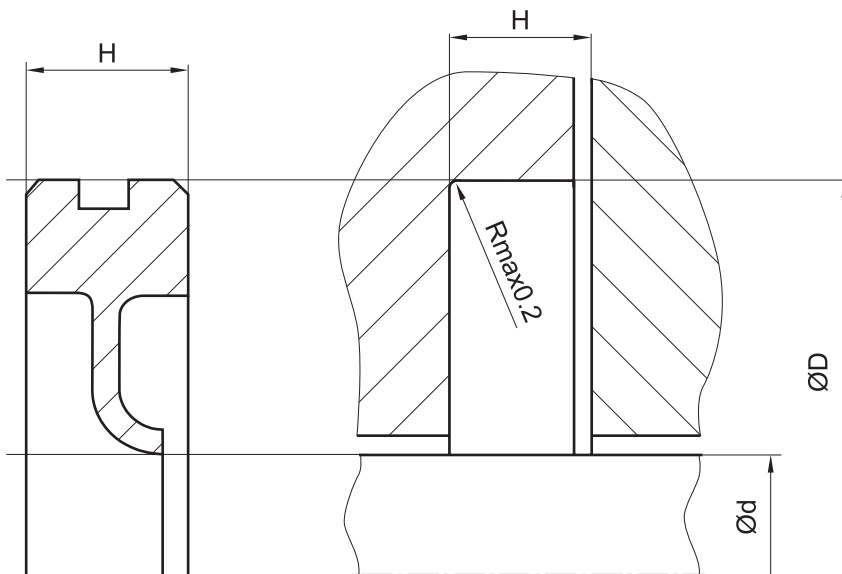

don't hesitate to contact our technical department for further information or for special requirements (temperature, speed etc.), so that suitable materials and/or designs can be recommended.